

STANDARD PITCHED ROOFLIGHT  
External weathered kerb size: 1000mm x 2000mm

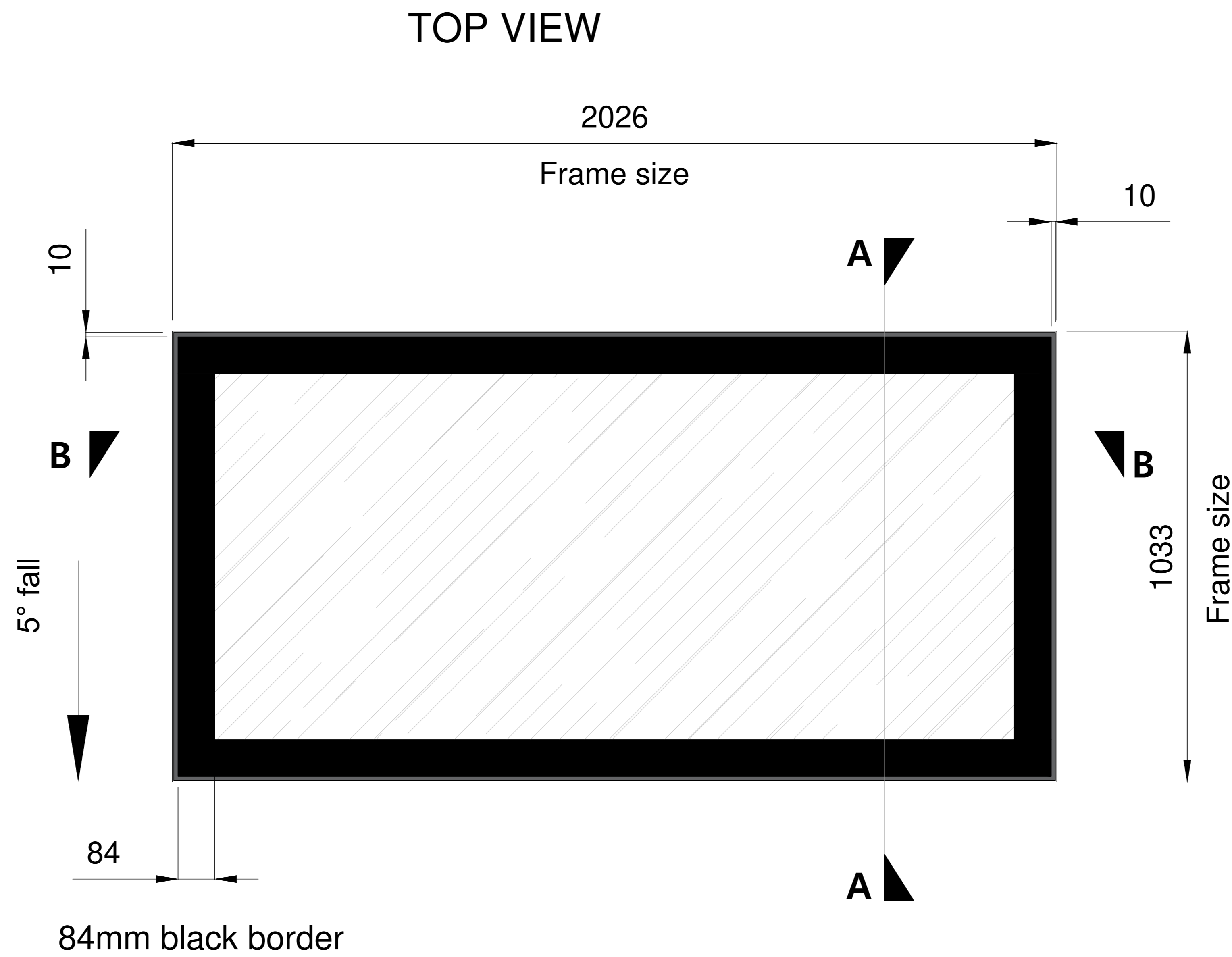
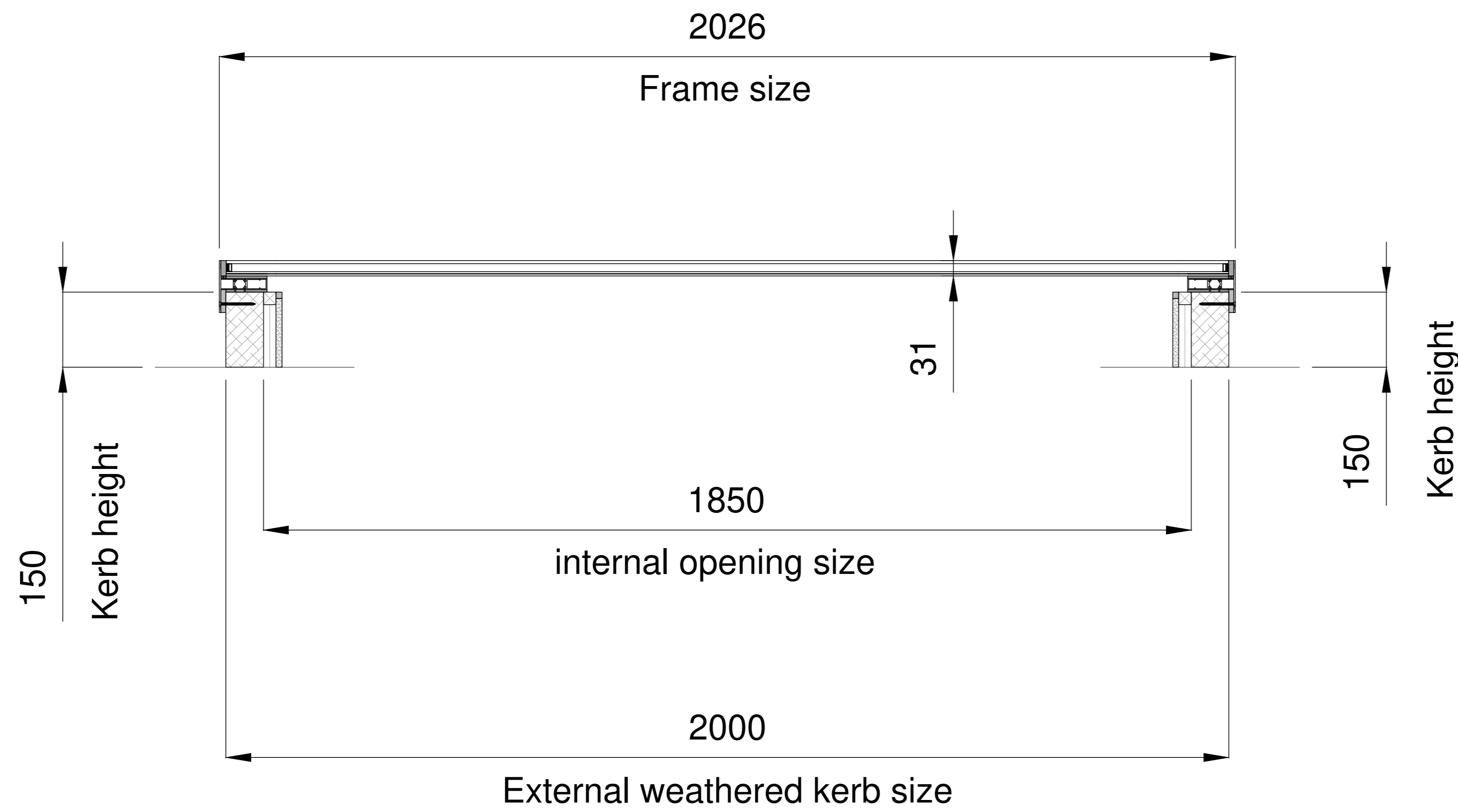
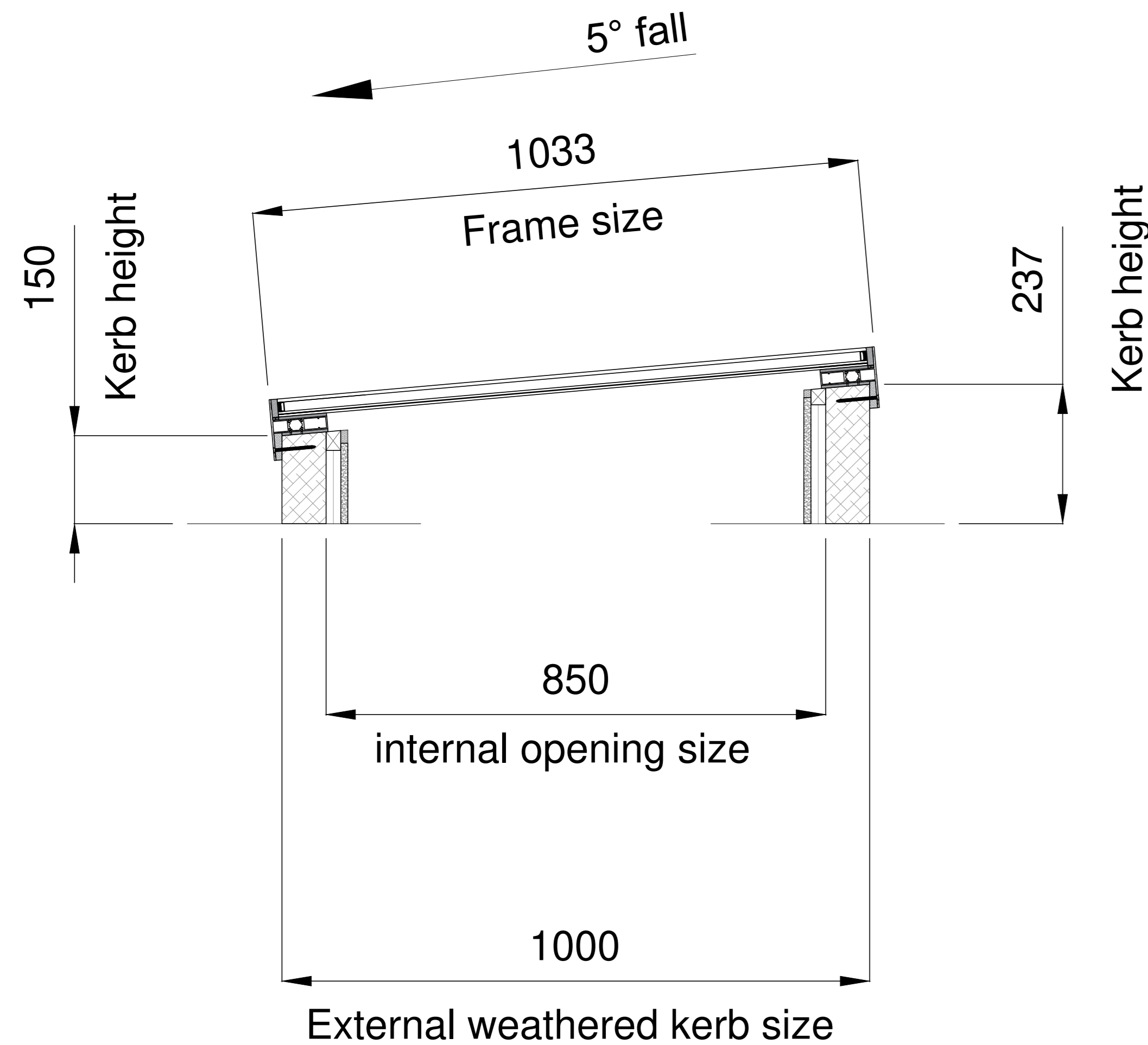

- Disclaimer:**
- Overhead Glazing Limited continuously improves its products and services and therefore reserves the right to modify, alter or change the design details.
  - Any change will be made at our discretion and without the need for prior notice.
  - The copyright for this drawing belongs to and is the sole property of Overhead Glazing Limited.
  - The design and information contained in this drawing is private and confidential.
  - It must not be duplicated, presented in any way or communicated to any third party.
  - It must not be used for any purpose other than that for which it was originally issued without the written consent of **Overhead Glazing Limited**.

- General Notes:**
- Do not scale from drawings.
  - Contractor is to cross check with Architect /project manager if uncertainty may arise.
  - Working drawings is to be thoroughly analysed by the general contractor before the commencement of the construction.
  - All dimensions are in millimetres(mm) & levels in meters(m) unless noted otherwise.
  - This drawing to be read in conjunction with all relevant specifications.
  - All work to comply with the relevant British Standards, GGF Codes of Practice and Building Regulations if non exempt.

Drawing title: Standard Pitched Rooflight 1000mm x2000mm  
Drawing No: ST-R 0004

GLAZING: Double glazed unit manufactured from:  
  
6mm HST toughened outer pane ( outside edge to be polished )  
16mm cavity with Argon filled  
8.8mm clear Low-E laminated inner pane  
31mm o/all thickness

Approval Date : .....

Customer signature : .....

Manufacturing / installation date .....

Drawn : Florin Dan Lefter

Checked : Nader Dehnad

Approved : **TBC by customer prior manufacture**

Date : 24.01.2021

DRG. No. **ST-R 0004** Proposal

Standard Pitched Rooflight  
1000mm x2000mm ( Enlarged kerb detail )



**OVERHEAD GLAZING LIMITED**  
0208 0500 600 sales@overheadglazing.co.uk  
71-75 Shelton Street, London, Greater London,  
United Kingdom, WC2H 9JQ

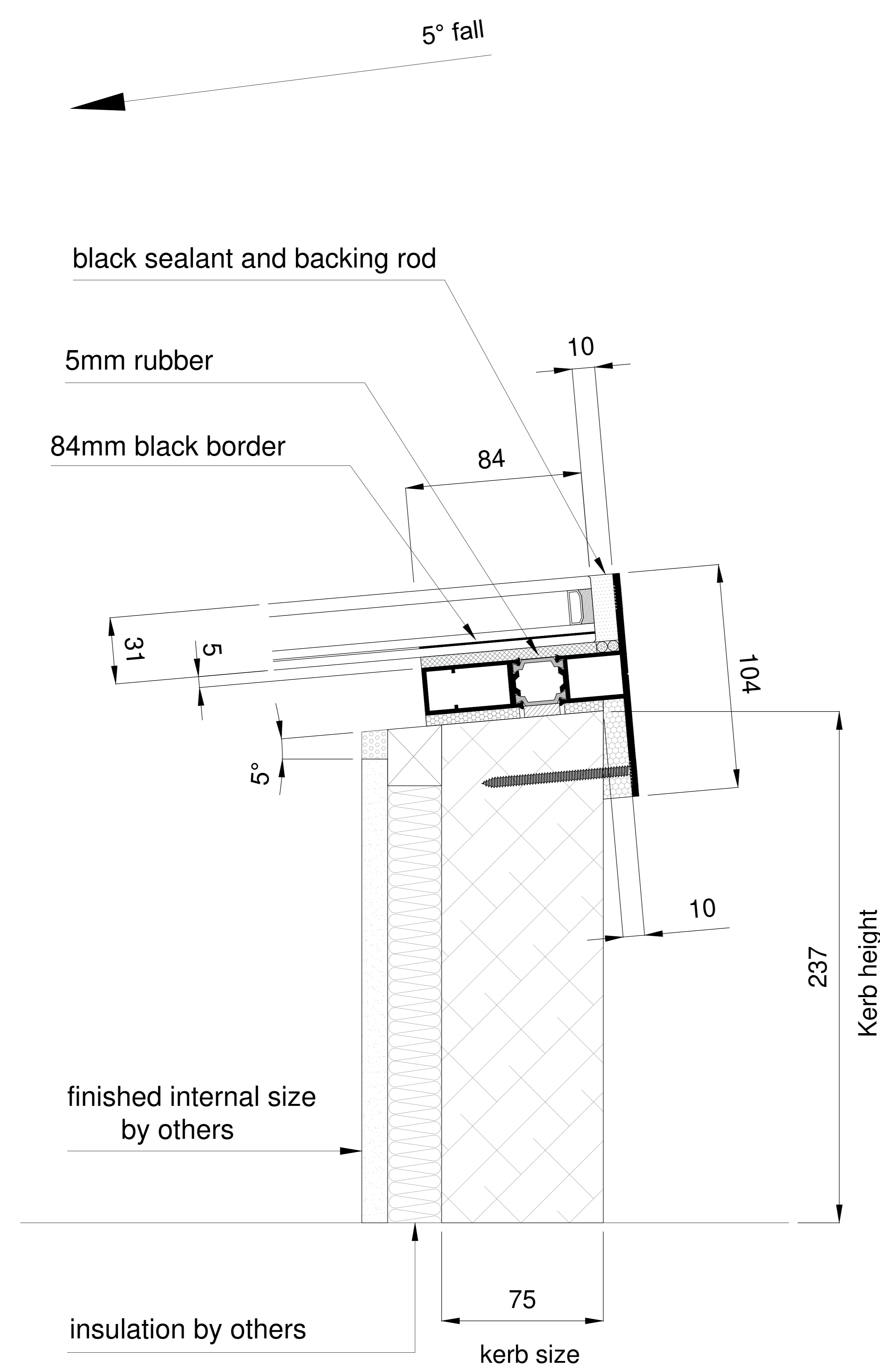

NOTE: STANDARD ROOFLIGHT  
External weathered kerb size 1000mm x 2000mm  
is a critical dimnsion to ensure the rooflight fits  
over the outside kerb

- Disclaimer:**
1. Overhead Glazing Limited continuously improves its products and services and therefore reserves the right to modify, alter or change the design details.
  2. Any change will be made at our discretion and without the need for prior notice.
  3. The copyright for this drawing belongs to and is the sole property of Overhead Glazing Limited.
  4. The design and information contained in this drawing is private and confidential.
  5. It must not be duplicated, presented in any way or communicated to any third party.
  6. It must not be used for any purpose other than that for which it was originally issued without the written consent of **Overhead Glazing Limited**.

- General Notes:**
1. Do not scale from drawings.
  2. Contractor is to cross check with Architect /project manager if uncertainty may arrise.
  3. Working drawings is to be thoroughly analysed by the general contractor before the commencement of the construction.
  4. All dimensions are in millimetres(mm) & levels in meters(m) unless noted otherwise.
  5. This drawing to be read in conjunction with all relevant specifications.
  6. All work to comply with the relevant British Standards, GGF Codes of Practice and Building Regulations if non exempt.

Drawing title: Standard Pitched Rooflight 1000mm x2000mm  
Drawing No: ST-R 0004

GLAZING: Double glazed unit manufactured from:  
  
6mm HST toughened outer pane ( outside edge to be polished )  
16mm cavity with Argon filled  
8.8mm clear Low-E laminated inner pane  
31mm o/all thickness

Approval Date :	.....
Customer signature :	.....
Manufacturing / installation date	.....
Drawn :	Florin Dan Lefter
Checked :	Nader Dehnad
Approved :	<b>TBC by customer prior manufacture</b>
Date :	24.01.2021
DRG. No.	<b>ST-R 0004</b>
	Proposal

Standard Pitched Rooflight  
1000mm x2000mm ( Enlarged kerb detail )

OVERHEAD

GLAZING

OVERHEAD GLAZING LIMITED

0208 0500 600 sales@overheadglazing.co.uk

71-75 Shelton Street, London, Greater London, United Kingdom, WC2H 9JQ